

## Protecta FR Acrylic 150mm Solid Timber or CLT Floor Steel, Copper, Alupex Pipe (Interrupted Insulation)

### Installation Instructions

1. Before installing Protecta® FR Acrylic ensure that the surface of all service penetrations and surrounding construction is free from all loose contaminants, dust and grease.
2. Install the backing material. Cut this slightly oversize and insert into the gap ensuring a tight friction fit. Ensure correct depth is achieved.
3. Fill the gap or joint with Protecta® FR Acrylic on both sides to the required depth.
4. Apply the sealant generously to prevent air bubbles. Finish the bead with a moist spatula, pallet knife or brush.
5. Protecta® FR Acrylic can be over-painted with most emulsion or alkyd (gloss) paints.

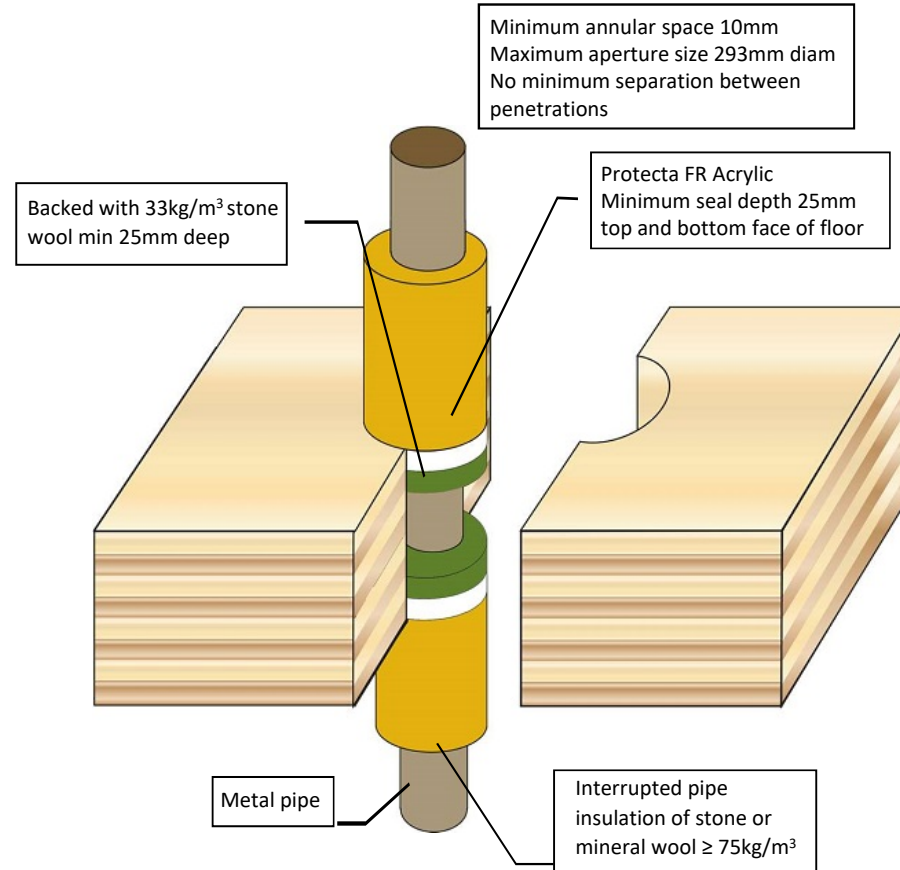

System/FPA Register ID# FC414

<b>Products</b>	Protecta FR Acrylic Stone wool
<b>Application</b>	Fire stopping of metal pipes in timber floors
<b>Construction</b>	Minimum floor thickness of 150mm and comprise solid timber or CLT with a minimum density of 480kg/m³.

### Fire & Sound classification

Steel pipe up to 273mm diam (up to 14.2mm wall) with 25mm thick insulation for 500mm	FRR -/120/60
Copper or steel pipe up to 15mm diam (up to 7.5mm wall) with 20mm thick insulation 500mm	FRR -/120/120
Copper or steel pipe up to 54mm diam (up to 14.2mm wall) with 20mm thick insulation 500mm	FRR -/120/90
Alupex pipe up to 16mm diam (up to 2.3mm wall) with 20mm thick insulation for 500mm	FRR -/120/120
Alupex pipe up to 75mm diam (up to 4.6mm wall) with 25mm thick insulation for 500mm	FRR -/120/90

ZERO smoke leakage up to 200Pa

Sound reduction (seal only) STC 62

Sheet size: **A4** | Drawn date & no: 24/5/21

Scale: **NTS** | Drawn by: **K.B**

As a part of our policy of on-going product development and testing, we reserve the right to modify, alter or change product specifications without giving notice. All information contained in this document is given in good faith and is provided for guidance only. Any drawings provided are for illustrative purposes only. As Polyseam has no control over the methods or competence of installation and of prevailing site conditions, no warranties, expressed or implied, is intended to be given as to the actual performance of the product mentioned or referred to herein and no liability whatsoever will be accepted for any loss, damage or injury arising from the use of the information given.